

# Commuter Car Park Program West Ryde



*Indicative artist's impression of the proposed West Ryde commuter car park, subject to detailed design.*

## More commuter car parking is coming to West Ryde Station

Planning is underway to deliver additional commuter car parking spaces at West Ryde to provide you with more convenient access to public transport and help ease congestion on our roads.

Key features of the proposal include:

- a new commuter car park with approximately 100 additional spaces at the existing car park site to the east of West Ryde Station
- accessible parking spaces, motorcycle parking bays and bicycle parking hoops
- dedicated paths to provide safe and convenient access between the car park and the station
- provision for future electric vehicle charging spaces
- free parking for up to 18 hours with Transport Park & Ride, just tap on to your connecting public transport trip with your Opal card
- lighting, wayfinding signage and new rail corridor fencing for improved safety
- landscaping within the car park, including tree planting along the Ryedale Road footpath.

Subject to planning approval, construction of the project is planned to begin in early 2021 and is expected to be completed by late 2021.

## Key features of the proposed West Ryde Commuter Car Park

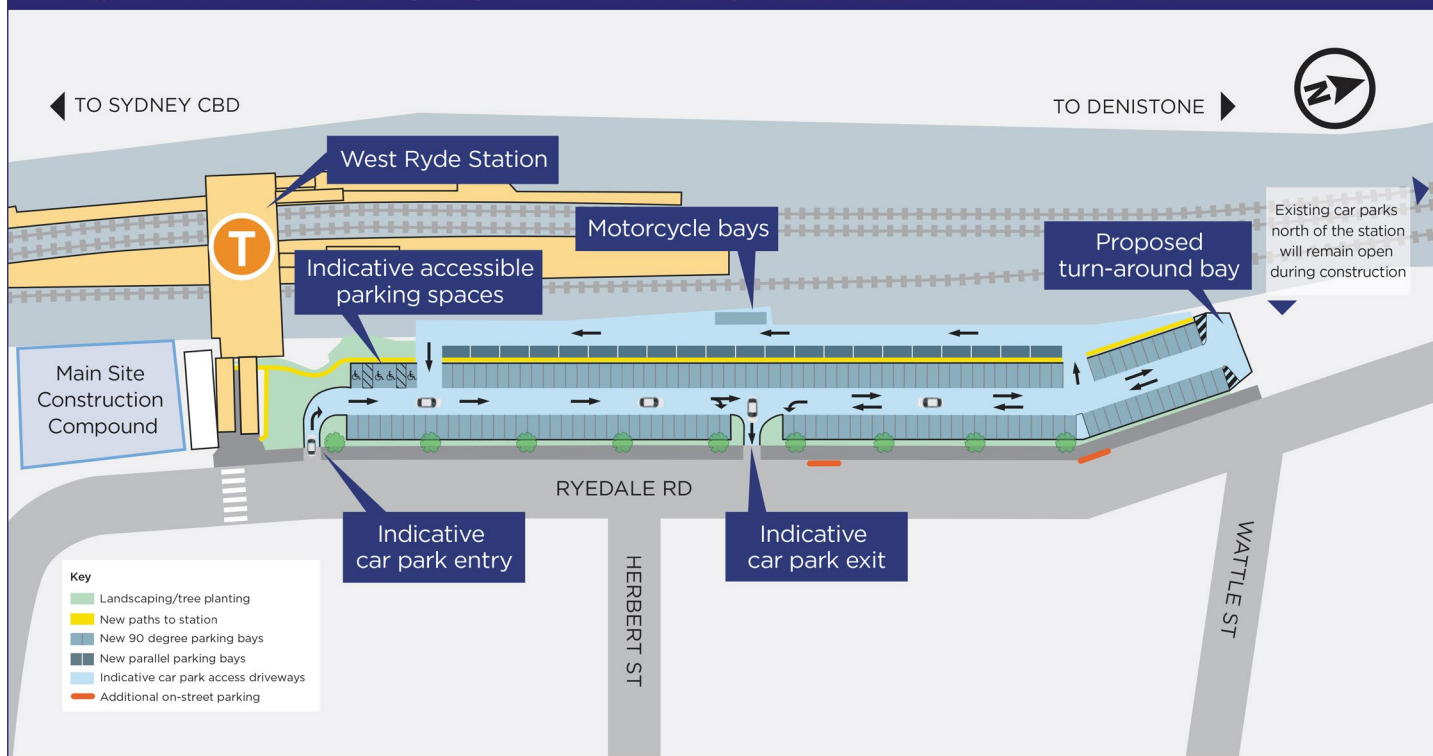

Site map of the new commuter car park, subject to detailed design

### Parking during construction

During construction, the commuter car park directly next to the station will close in order to complete the work safely. The commuter car parks located further north will remain open during construction.

### Have your say on the concept plans

You can view and provide feedback on the concept design by completing the online feedback form on our website at [www.transport.nsw.gov.au/westryde](http://www.transport.nsw.gov.au/westryde), calling 1800 684 490 or emailing [projects@transport.nsw.gov.au](mailto:projects@transport.nsw.gov.au).

### Keeping you up to date

We will continue to keep you informed about the project through notifications to customers, local residents and businesses and frequent updates published on our website: [www.transport.nsw.gov.au/westryde](http://www.transport.nsw.gov.au/westryde).

If you have any questions or would like to sign up to receive regular project updates via email, please contact us on 1800 684 490 or email [projects@transport.nsw.gov.au](mailto:projects@transport.nsw.gov.au).

### Commuter Car Park Program

The Commuter Car Park Program is a NSW Government initiative to provide you with more convenient access to public transport at key transport interchanges, and help ease congestion on our roads. We have already delivered more than 10,000 commuter car spaces across Sydney since 2011, with around 8,000 additional spaces on the way.



This document contains important information about public transport projects in your area. If you require the services of an interpreter, please contact the Translating and Interpreting Service on **131 450** and ask them to call Transport for NSW on **(02) 9200 0200**. The interpreter will then assist you with translation.

For more information call 1800 684 490

Email [projects@transport.nsw.gov.au](mailto:projects@transport.nsw.gov.au) or visit [transport.nsw.gov.au/westryde](http://transport.nsw.gov.au/westryde)

